

- 4-Exterior Weather & Air Barrier
- 5-Thermal Insulation
- 17-Rafter
- 28-FTT U6 FAKRO pivot window
- 31-Thermal insulation of FAKRO flashing
- 38-Installation bracket
- 109-Vapor Barrier
- 227-EBV-AT THERMO flashing side element FAKRO
- 228-EBV-AT THERMO flashing upper element FAKRO
- 229-EBV-AT THERMO flashing lower element FAKRO

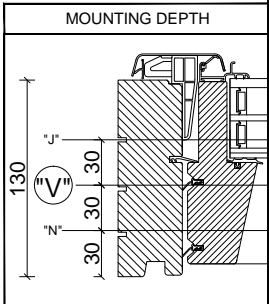

FTT U6 - DIMENSIONS									
Window size[in]	B [in]	B [mm]	L [in]	L [mm]	Rough opening				
					W [in]	W [mm]	R [in]	R [mm]	
22x38	21 1/2	547	38 5/8	981	22 1/2	571	39 1/2	1000	<div>FTT U6</div> <div>EBV-AT</div> <div>SEAMED SHEET</div>
30x46	30 1/4	777	46 1/2	1181	32 1/4	817	48	1220	
30x55	30 1/4	777	55	1401	32 1/4	817	56 1/2	1440	
<div>FAKRO</div>					15° - 70°		15° - 90°		
Vertical and horizontal cross-section: FTT U6 roof window with EBV-AT THERMO flashing for flat tiled roofs (SEAMED SHEET)					FORMAT: A3		SCALE: 1:10/1:5		DATE: 10.2022